

Droppers

CONTACT WIRE DROPPER CLAMP

These clamps are used for current carrying droppers

Application:

- Droppers for short system heights
- For current carrying droppers
- Where small and lightweight dropper clamps are required

Material:

- Forged parts: CuNi2Si (UNE-EN 12165)
- Screw: St. Steel (A2-70) (EN ISO 3506)
- Washer: St. Steel (A2) (EN ISO 3506)

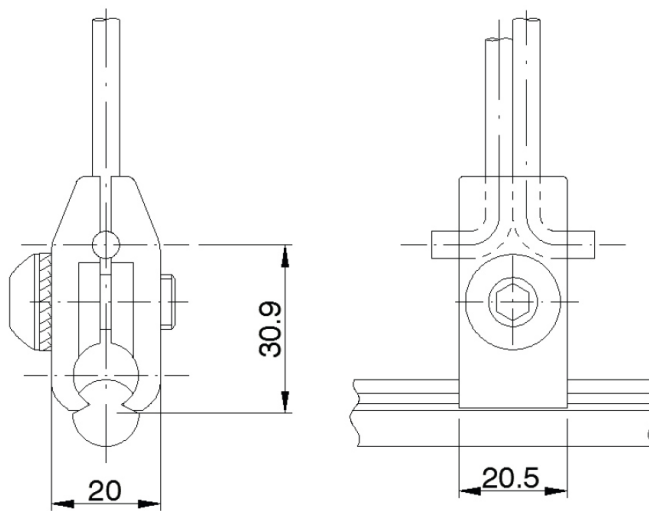

| No. | ID-code | Contact wire | Tightening Torque | Weight |
|-------------|----------|----------------|-------------------|--------|
| | | | (Nm) | (kg) |
| 625 020 001 | EPEN 108 | AC/BC 80 - 150 | 30 | 0,105 |